

Series 85
Smart Lock
User Manual

Specifications

- Product Name: Series 85 smart lock
- Power Supply: 4.9V to 6.0V (4*AA Alkaline Batteries)
- Static Current: $\leq 200\mu\text{A}$ (Average power consumption)
- External Emergency Power Supply: 5V1A Type-C
- User Capacity: Total capacity: 250
 - Maximum number of fingerprints: 100
 - Maximum number of passwords: 100
 - Maximum number of cards: 100
- Working Temperature: $-25^{\circ}\text{C} \sim 70^{\circ}\text{C}$
- Environmental Humidity: 15%RH~93%RH
- Card Type: M1
- Door Thickness: 35mm~90mm
- Antistatic Ability: $\geq 8\text{KV}$ (Contact type)
 $\geq 15\text{KV}$ (Non-contact)

Function Definitions

1. Menu: after the keypad is waken up, enter the "*" and "#" keys, and then verify the administrator fingerprint, or password or card to enter the setting menu.
2. ID Number: the user's identification, which is a unique number for each user.
3. Administrator: administrator has the highest management rights, who can unlock, add, delete users, even initialize the smart lock.
4. Normal Users: only have the basic unlock permission, no access to the "Menu" permission.
5. Tamper alarm: after initializing and powering on, the smart lock will enter the anti-pry monitoring state, if the outdoor unit was removed illegally, system will start horn alarm, in order to remind the clients to pay attention to the risk of illegal intrusion.
6. Low Battery Warning: when the battery voltage is lower to the warning voltage, the smart lock will remind clients to replace the batteries in time.
7. Factory reset: means that all registered information in the door lock system will be cleared, client can use any fingerprint, password, or card to enter the "Menu", even unlock.

Features

1. Adapt the latest AI self-learning fingerprint recognition algorithm, the fingerprints of the elderly and children can be accurately collected and identified.
2. When verify the password, you can enter the anti-peep password before and after the correct password.
3. Low battery warning, remind the user to replace the battery in time.
4. If verify fingerprint, password, or card wrong 5 times will warning, and system locked for 3 minutes to prevent malicious illegal test.

Product Overview(Unit:mm)

Outdoor Unit

Indoor Unit

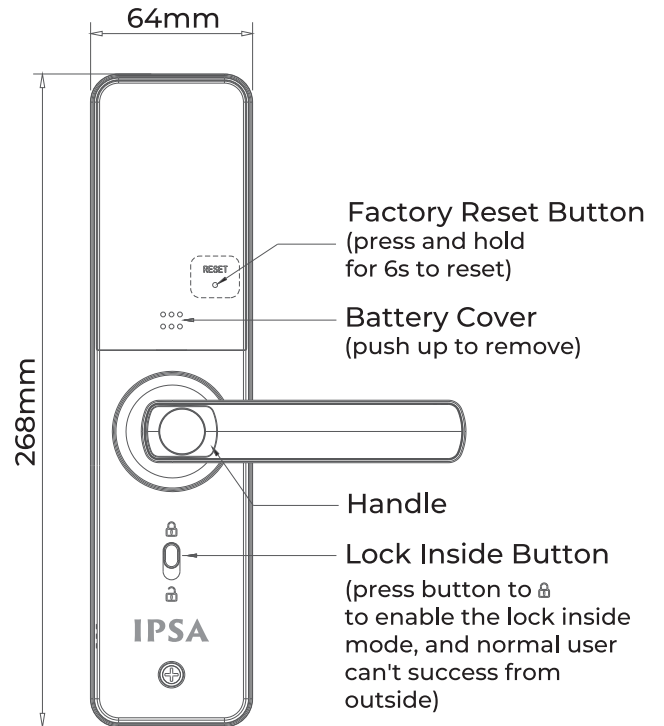
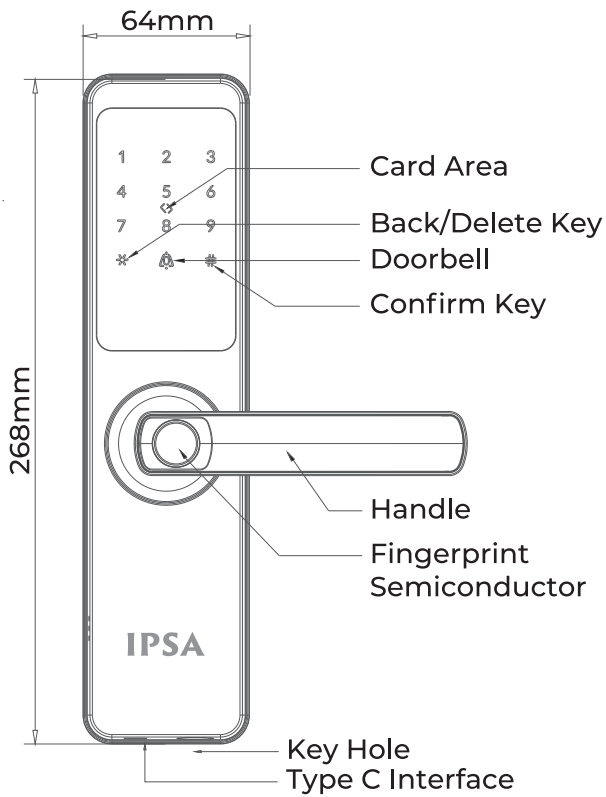

Outdoor Unit

Indoor Unit

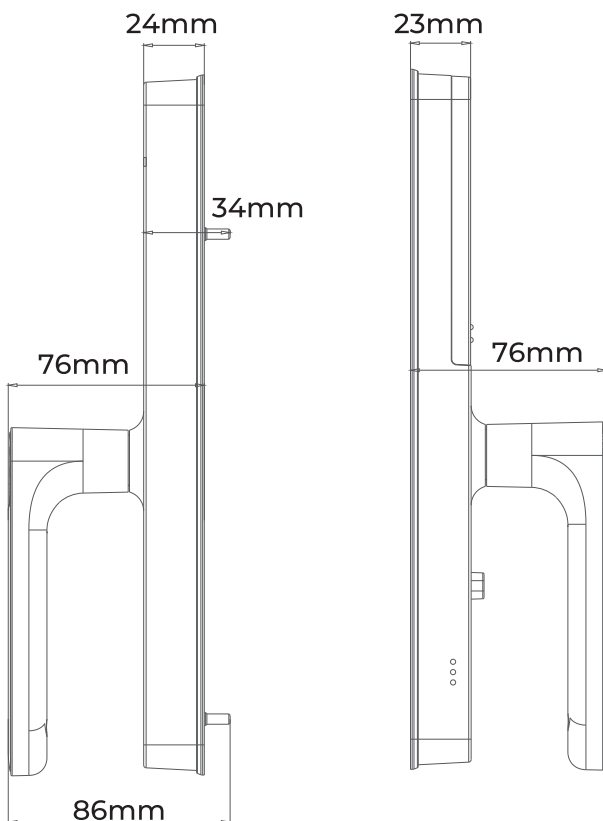

Process of Function Operations

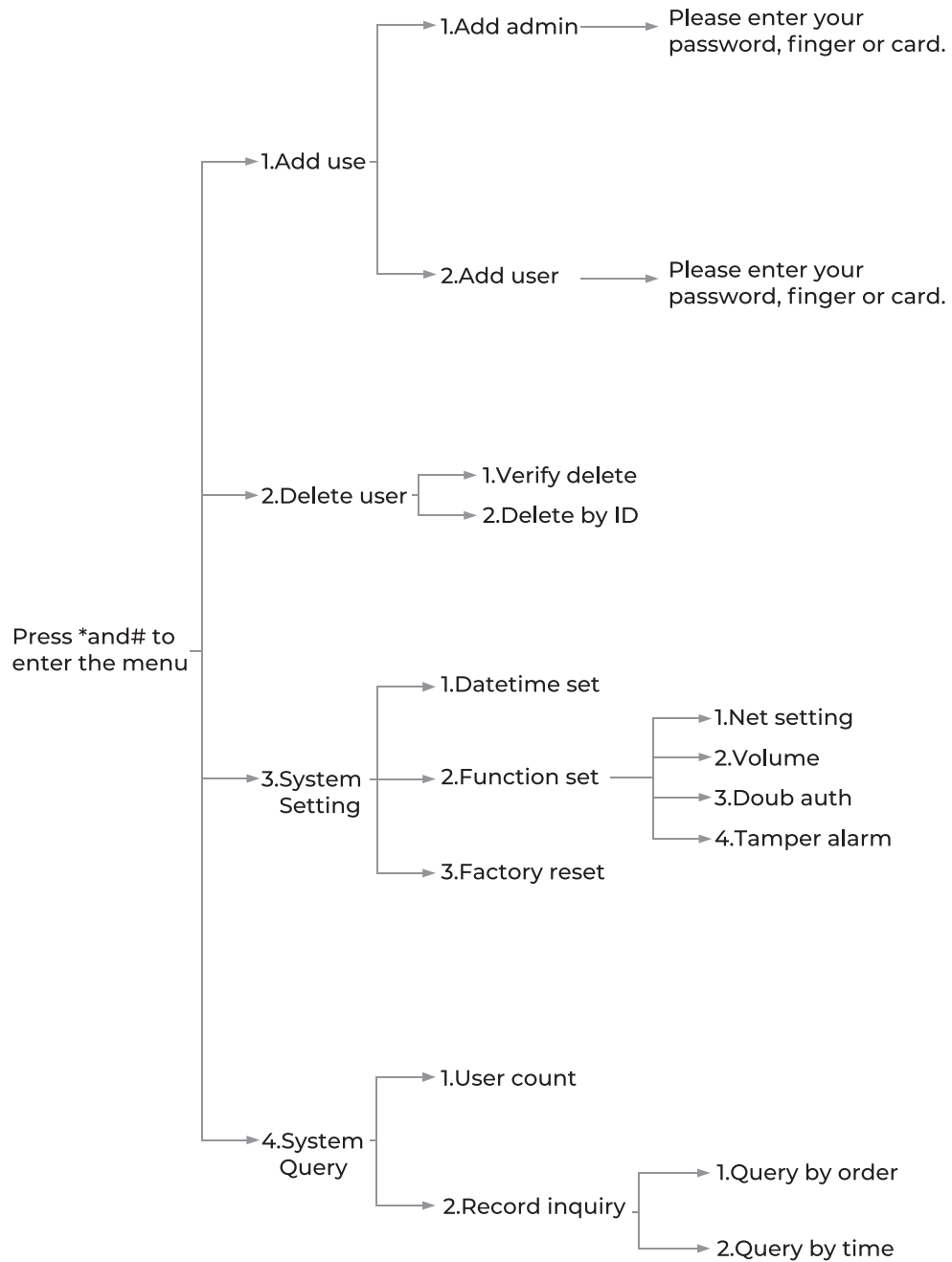

1.Add Administrator

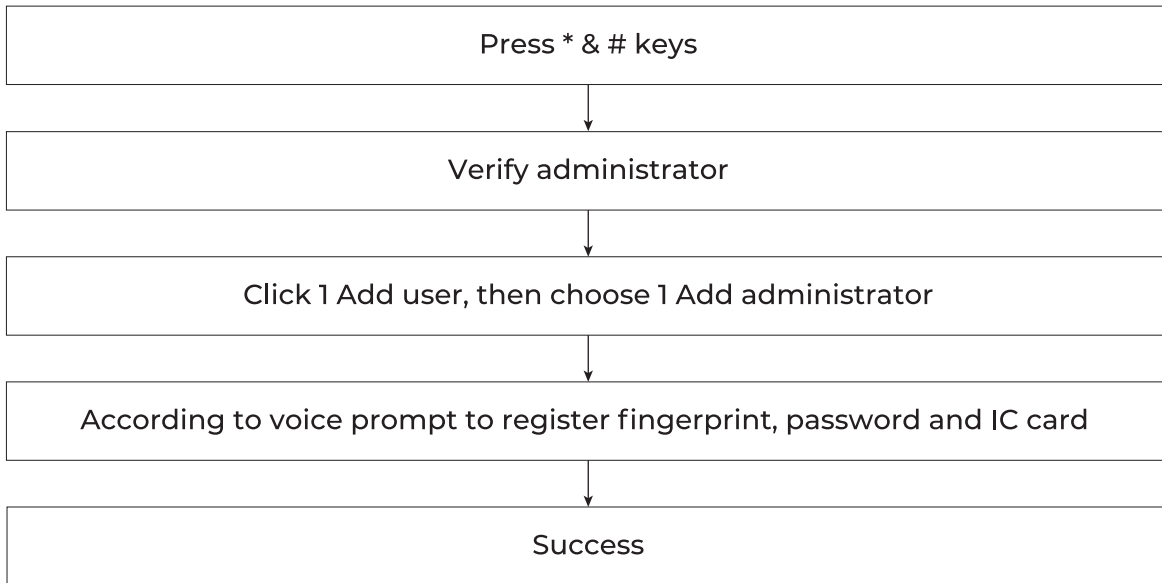

Note:

1. The administrator password user 000 has the highest privileges . Please keep it securely.
2. Password should be length 6 to 8digits.
3. Password end by # key, repeat 2 times.
4. Fingerprint registration repeat 5 times, and should change different fingerprint areas.

2.Delete User

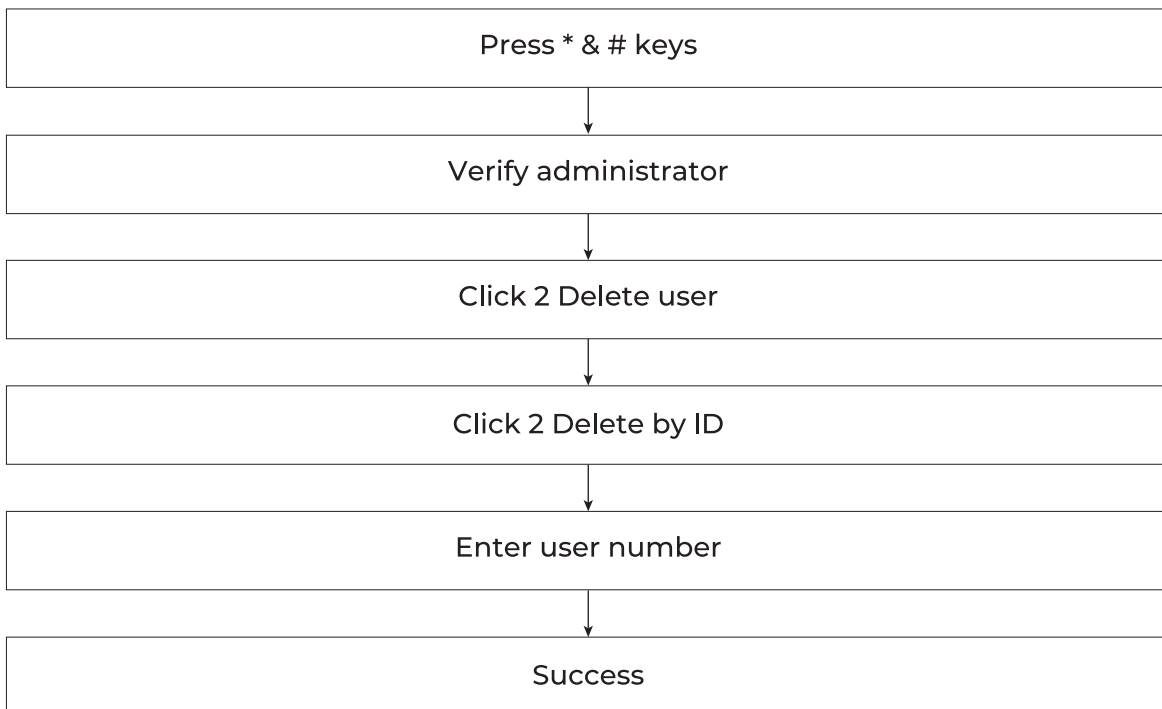

Note:

Can't delete the administrator who verifies entry into the menu.

3. Doub auth

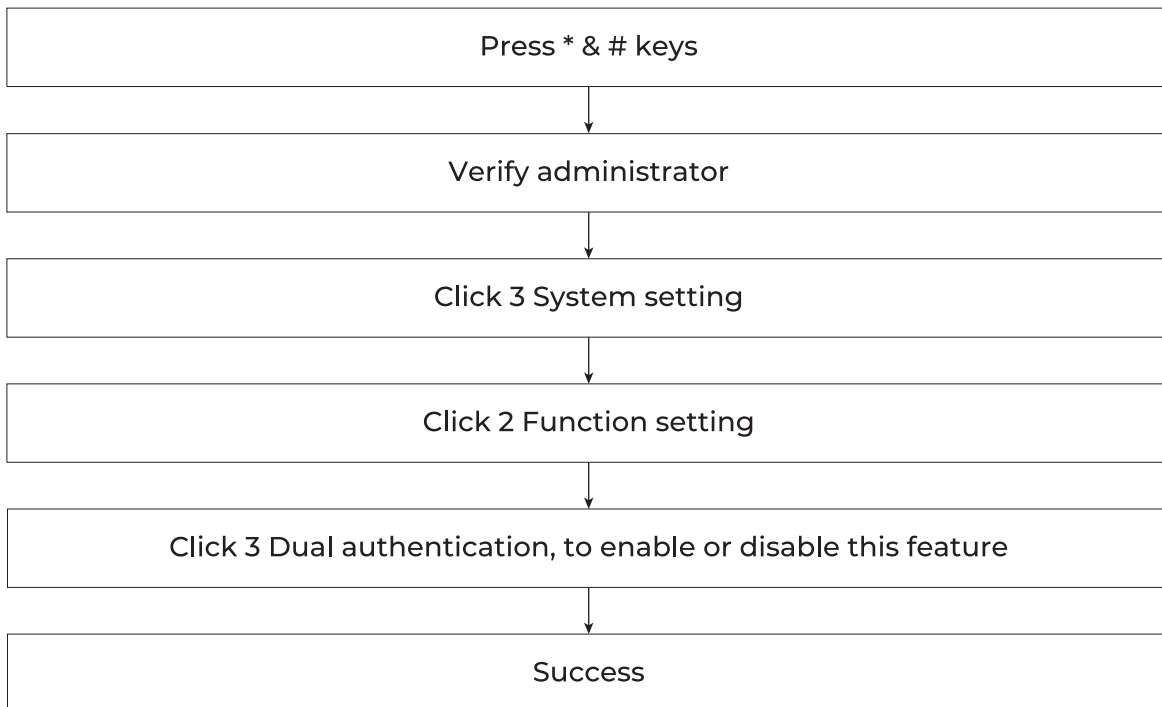

Note:

1. After enable the Double verification, need verify 2 types User, like fingerprint + password or card, and etc..
2. Double Verification is disable by default.

4. Tamper alarm

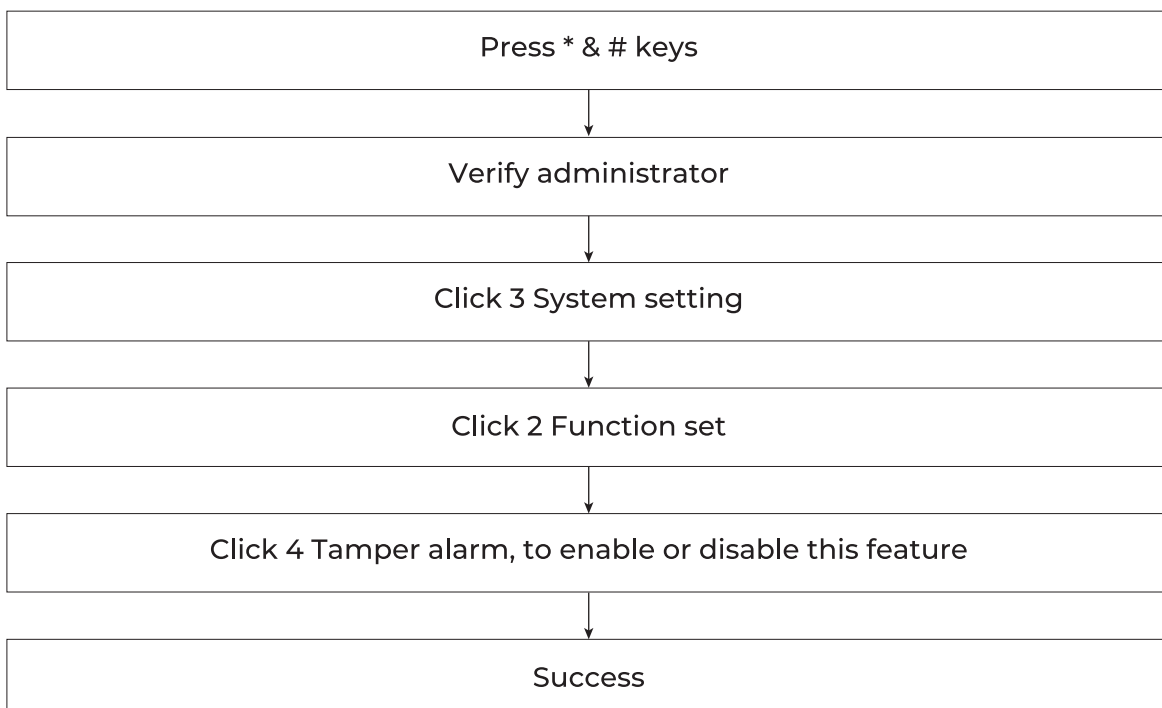

Note:

Tamper alarm is disable by default.

5. Volume Settings

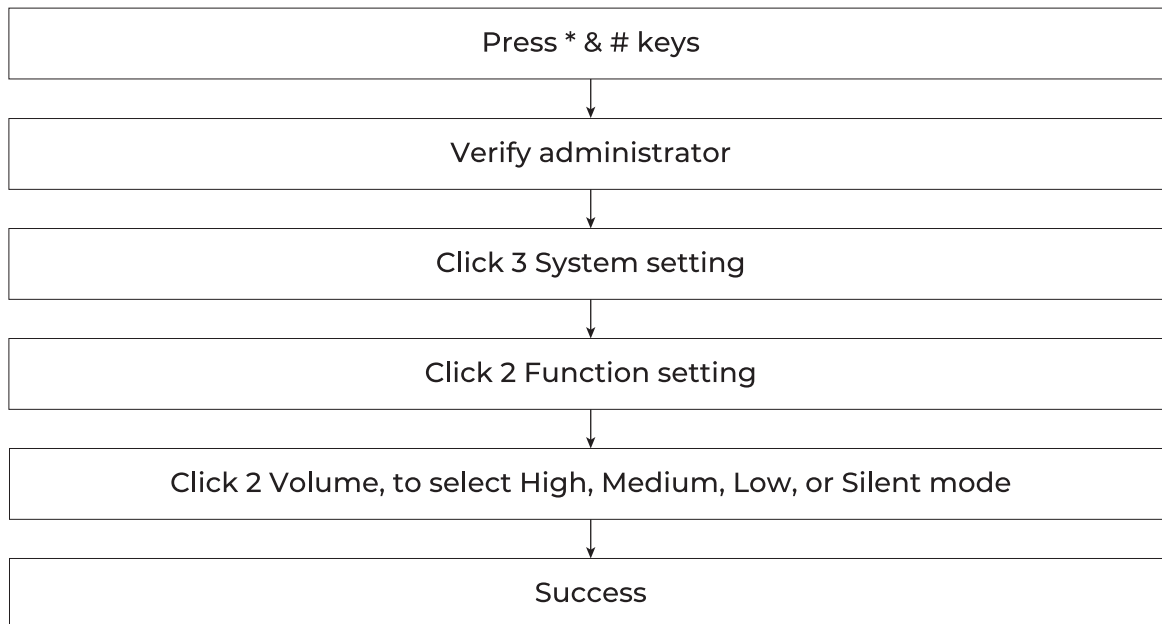

Note:

1. The volume can be adjusted according to the use scenario.
2. In the silent mode, there is no prompt sound for the switch lock, but the doorbell, alarm sound and menu broadcast functions are normal, and the safety prompt is not affected.

6. Language Settings

In the main interface, press 888# to enter the factory menu, enter the instructions, and press # key to set the language switch

3000# Chinese
3001# English
3003# Russian
3004# Vietnamese language
3006# Arabic language
3009# Spanish
3011# Indonesian Language
3012# Thai
3014# Turkish language
3018# Kazakh language
3023# Persian language

7.Factory reset

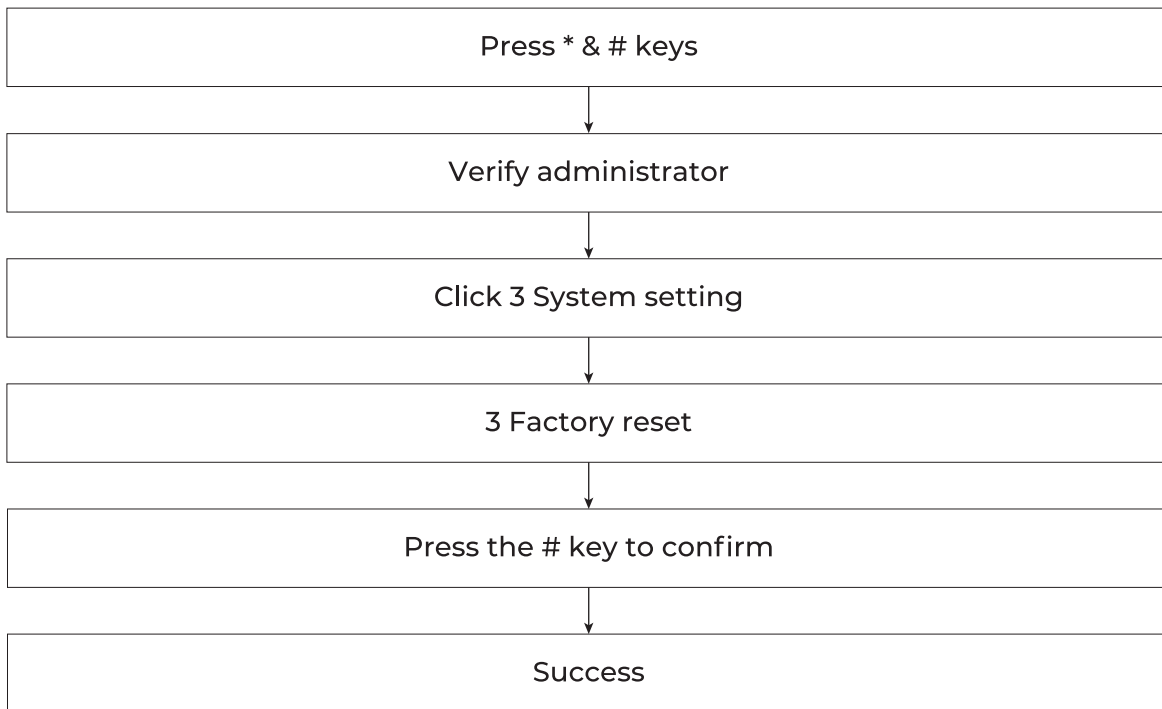

What's in box?

1. Indoor/outdoor Unit×2
2. IC Card×2
3. Mechanical Keys×2
4. Accessories package×1
5. Installation Template×1
6. Warranty Card×1
7. Usage Introduction Card×1

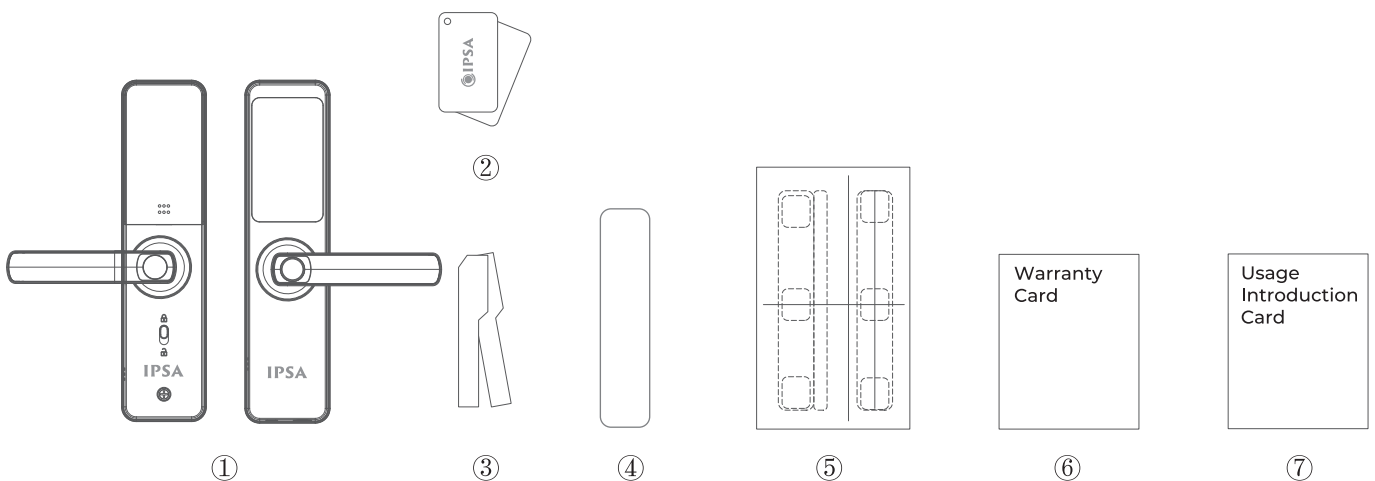

Important Notes

1. How to change batteries?

When low battery warning appears, please change all alkaline batteries.

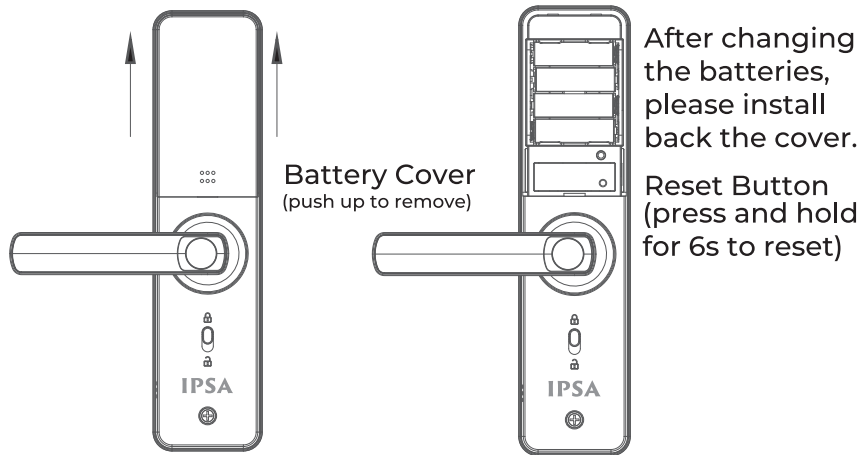

How to change handle directions?

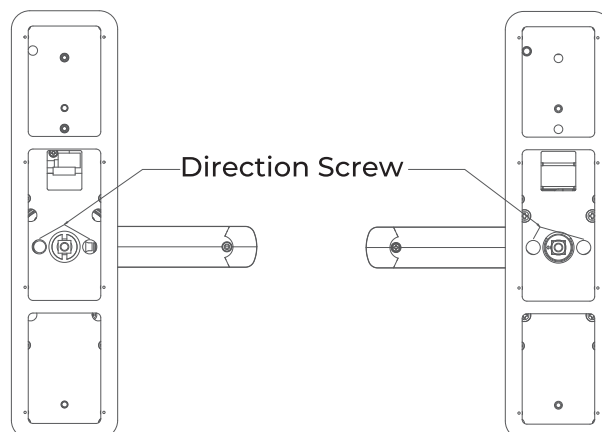
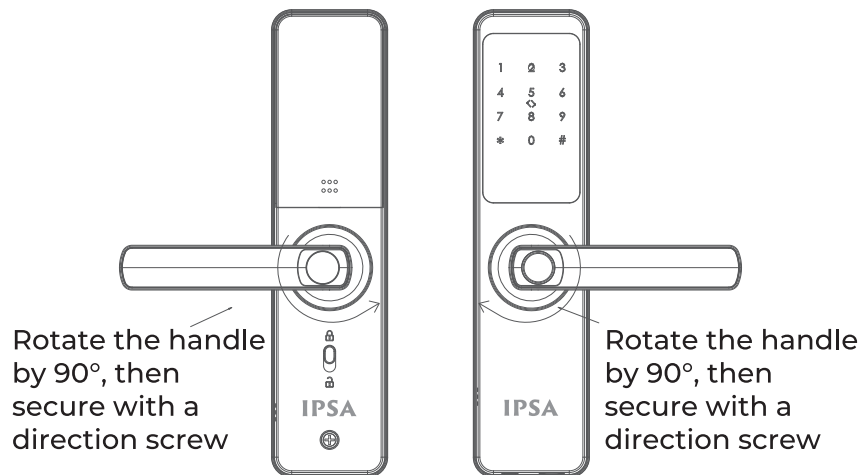

The name and content of hazardous substances in the product

In order to meet the relevant laws, regulations and other requirements of China's restriction of hazardous substances in electronic and electrical products, the hazardous substances in the products, classified by components, are declared as follows.

Parts	Toxic and Hazardous Substances or Elements					
	Lead (Pb)	Mercury (Hg)	Cadmium (Cd)	Hexavalent chromium (Cr(VI))	Polybrominated biphenyls (PBBs)	Polybrominated diphenyl ethers (PBDE)
Metal Fittings	×	○	○	×	○	○
Plastic Fittings	○	○	○	○	○	○
Printed circuit board assembly	×	○	○	○	○	○
Connecting cables	×	○	○	○	○	○
Collector	○	○	○	○	○	○
Touch screen	○	○	○	○	○	○

This form has been prepared in accordance with SJ/T11364

○ : indicates that the content of the hazardous substance in all homogeneous materials of the part is below the limit requirements specified in GB/T26572;

× : indicates that the content of the hazardous substance in at least a homogeneous material of the component exceeds the Limit requirements specified in GB/T26572;

Note 1: This product applies the concept of environmental protection design, the toxic and hazardous substances are effectively controlled, the toxic and hazardous substances or elements represented by "×" are mainly limited by the level of technological development, and the replacement of toxic and hazardous substances or elements cannot be realized.

Note 2: Some of the above classification vary depending on the specific product, and the actual product shall Prevail.

The "period of use" is shown in the figure. The "eco-friendly use period" of this product is 10 years, and the eco-friendly use period of replaceable parts such as batteries may differ from the eco-friendly use period of the product. The "Eco-Friendly Use Period" is valid only when this product is used under normal environment as described in this instruction manual.



This equipment contains a radio transmitting module with type approval code: CMIITID: 2020DP6462



For more support
connect to our customer care team:

IPSA BUSINESS INDIA PVT. LTD.
57/1/17-18, Site - 4, Industrial Area, Sahibabad, Ghaziabad,
Uttar Pradesh - 201010 INDIA.

Web : www.ipsaindia.com
E-mail : customercare@ipsaindia.com
Phone : +91 85050 10101