

CDL06

Cabinet Digital Lock

User Manual

Brief introduction

Touch Panel

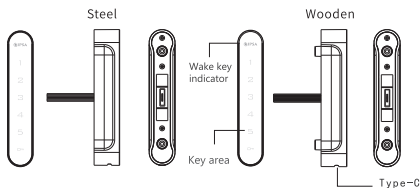

Lock body

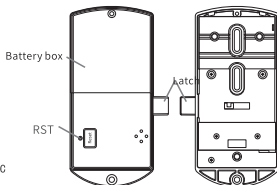

How to operate

1. There is a set of factory user password (1234) and a set of factory administrator password (4321) in the lock body before delivery. Password Permission: Administrator password > User password.
2. This lock has two modes of use, private and public, the default is private mode.
3. Power saving mode: In the case of no operation button, exit after 8 seconds and enter the power saving mode.

🔒 Lock & unlock 🔓

Unlock 🔓

1. Wake up keyboard, input the correct password and press "OK" to confirm, after a long "beep" sound, the green light is on,
2. The latch retracts automatically and opens within 5s.

Lock 🔒

The latch will stretch out automatically after 5s.



Note:

- * Password error three continuous beep
- * After unlocking successfully with the administrator password, the user password is automatically restored to the factory user password: 1234 ;
- * When buzzer beep 3 times and lock shows this signal 🔴 means low voltage.

How to set password

Change password

➢ For example : user password is changed 123123

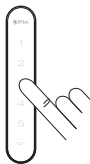

1. Wake up keyboard, input the factory user password "1234" + "OK", after a long "beep" the green light is on ;
2. Long press "OK" at least 3s, until buzzer gives out a long beep with the green light flash,
3. Input the new password "123123" + "OK", after a long "beep" the new password is successfully changed.

Note:

- * Perform this step to change the user password and administrator password.
- * Set a password of 4-15 characters. The administrator password cannot be the same as the user password.
- * Once the new password is set, the old password is invalid. Please remember and keep your new password safe, in case it gets lost.

Turn on/off public mode/set a temporary password

Turn on public mode

1. Wake up keyboard, input management password + "□", buzzer gives out a long beep, the green light is on,
2. Long press "□" at least 3s, until buzzer gives out a long beep with the green light flash press "□" again,
3. Input "4 4"+ "□", when you hear a long beep, means public mode already been turned on.

Note:

- * The administrator password must be used for this setting. The user password cannot be used.
- * In public mode, enter the administrator password to clear the temporary password and unlock it. Keep the administrator password safe.

Set a temporary password (only in public mode)

1. Wake up keyboard, input a password of 4-15 characters and press "□" to confirm. After a long "beep" the temporary password is successfully set.

Note:

- * Temporary password is valid once and automatically invalid after use.
- * After the temporary password is set, the green light flashes every 3 seconds.

Turn off public mode

1. Wake up keyboard, input management password + "□", buzzer gives out a long beep, the green light is on,
2. Long press "□" at least 3s, until buzzer gives out a long beep with the green light flash, press "□" again,
3. Input "4 3"+ "□", when you hear a long beep, means public mode already been turned off.

Turn on/off Fake Pin code function

1. Input management password + "□", buzzer gives out a long beep, the green light is on,
2. Long press "□" at least 3s, the green light flash, press "□" again,
3. Input "4 2"+ "□", when you hear a long beep, means Fake Pin code function already been turned on.
Input "4 1"+ "□", when you hear a long beep, means Fake Pin code function already been turned off.

Note:

- * You can enter a maximum of 16 characters password, as long as one of the consecutive passwords is the same as the set password, the password authentication passes.
- * When the virtual password function is enabled, you can enter garbled characters before and after the correct password to hide the real password. To keep others from prying eyes.

Features

1.Decode

- When password been forgotten, you can get the decode number by calling service number. The password will be changed back to the factory default management password "4321", user password "1234"; clear code and unlock, do not restore mode.
- Dedicated TypeC-KEY(need to buy from agents), clear code and unlock, do not restore mode.

2.Restore factory settings

Long press the RST button to release until "beep", clear code without unlocking, password will be restored factory settings, do not restore mode.

3.Password error alarm

Auto-alarm will be activated when input wrong password 4 times and the lock will be died for 60s.

4.Low voltage

The lock may not work if the voltage is too low, you can connect the Type-C port with an external power supply.

5.Battery undervoltage warning:

The red light is on when the keyboard keys are started. After entering the correct password, "beep" three short sounds, and the lock can be unlocked normally. At this time, the electronic lock is in the low voltage working state, please replace the new battery in time.(Note: Too low battery voltage will cause the electronic lock cannot be unlocked)

Fixing hole size & installation

▼ Installation

► Fixing hole size Unit: mm

*Thickness range of the wooden door: 15mm-25mm
*Thickness range of the metal door: 0.6mm-2mm

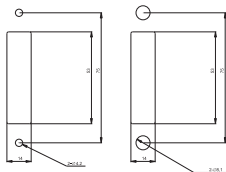

Wooden hole size

Steel hole size

(1)

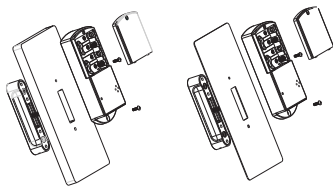

Wooden mounting

Steel mounting

(2)

IPSA BUSINESS INDIA PVT. LTD.

57/1/17-18, Site - 4, Industrial Area, Sahibabad, Ghaziabad, Uttar Pradesh - 201010 INDIA.

Web : www.ipsaindia.com | E-mail : customercare@ipsaindia.com | Phone : +91 85050 10101